

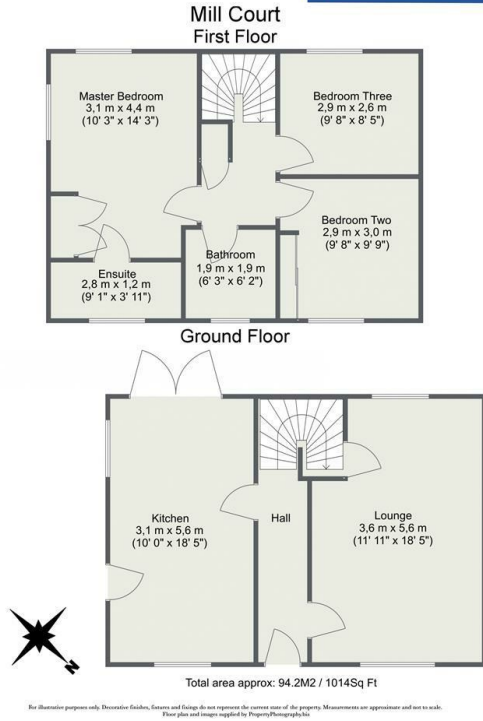

The Weir, 8 Mill Court, Alvechurch, Birmingham, B48 7JY

£1,500 Per Month

- Three Bedrooms
- Master Bedroom having en-suite
- Popular Development in desirable Village
- Available now
- Kitchen/Diner
- Family Bathroom
- Rear & side garden, communal garden
- Lounge with downstairs cupboard
- Garage & parking
- Gas Central Heating



Directions

From Red Lion Street Turn left onto The Square Continue straight onto Radford Rd Turn right onto Mill Court Turn left to stay on Mill Court Destination will be on the left Arrive: Mill Court, Alvechurch, B48 7JY

Viewings

Viewings by arrangement only. Call 0121 453 8447 to make an appointment.

Council Tax Band

B

EPC Rating:

C

Energy Efficiency Rating		Current	Potential
<i>Very energy efficient - lower running costs</i>			
(92 plus) A			
(81-91) B		75	86
(69-80) C			
(55-68) D			
(39-54) E			
(21-38) F			
(1-20) G			
<i>Not energy efficient - higher running costs</i>			
England & Wales		EU Directive 2002/91/EC	